

# Making neighbourhoods

HK201

## Phased delivery

The masterplan that was granted planning permission in July 2020 will be further developed in detail and built out over a number of years, creating new places complete with buildings, roads, gardens and local facilities.

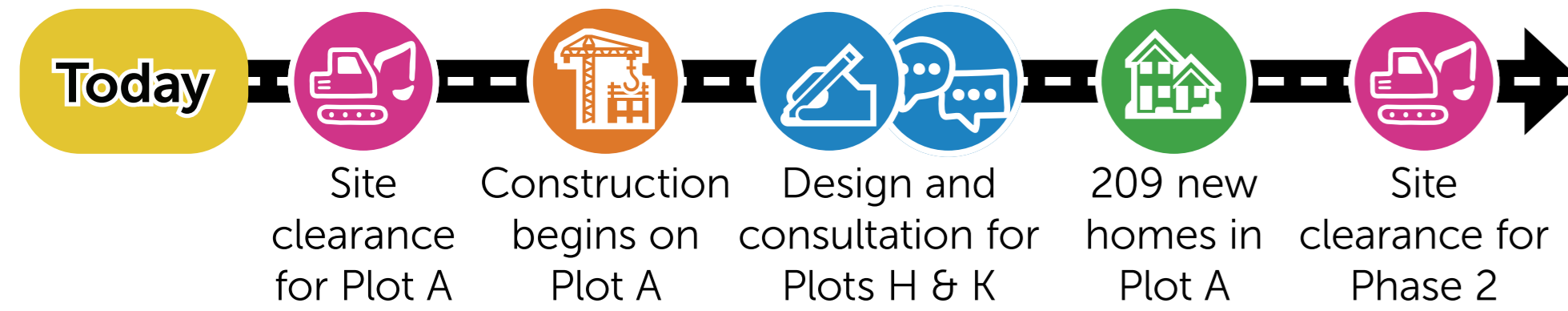

The first new buildings  
Artist's impression CGI view of Plot A

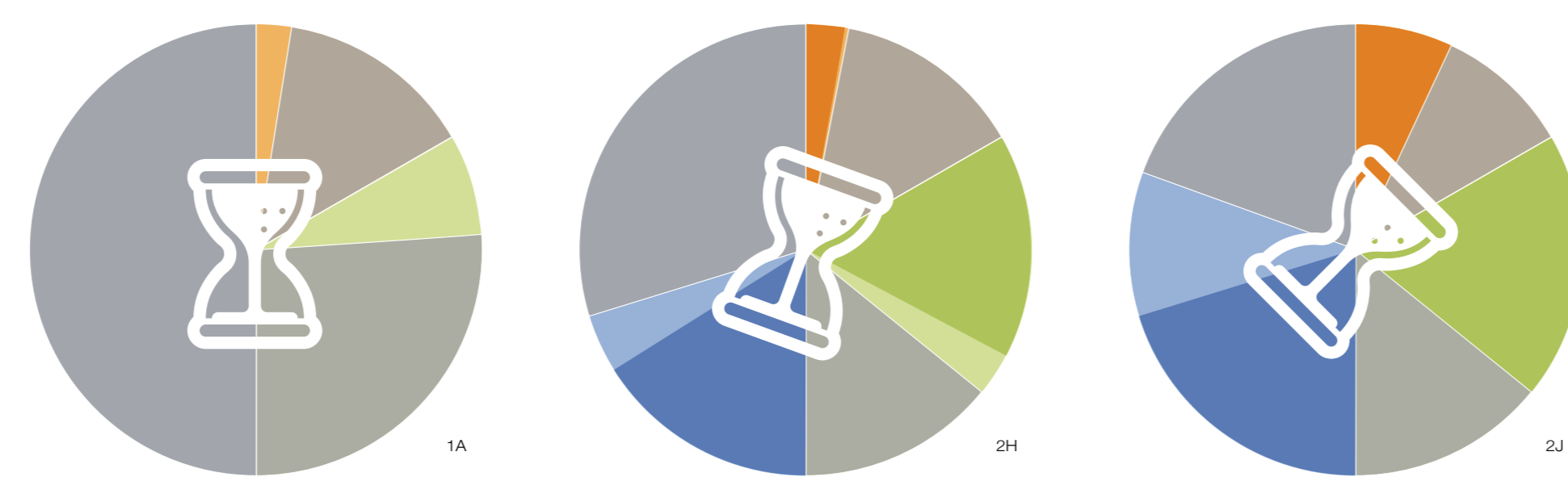

by 2025  
209 homes

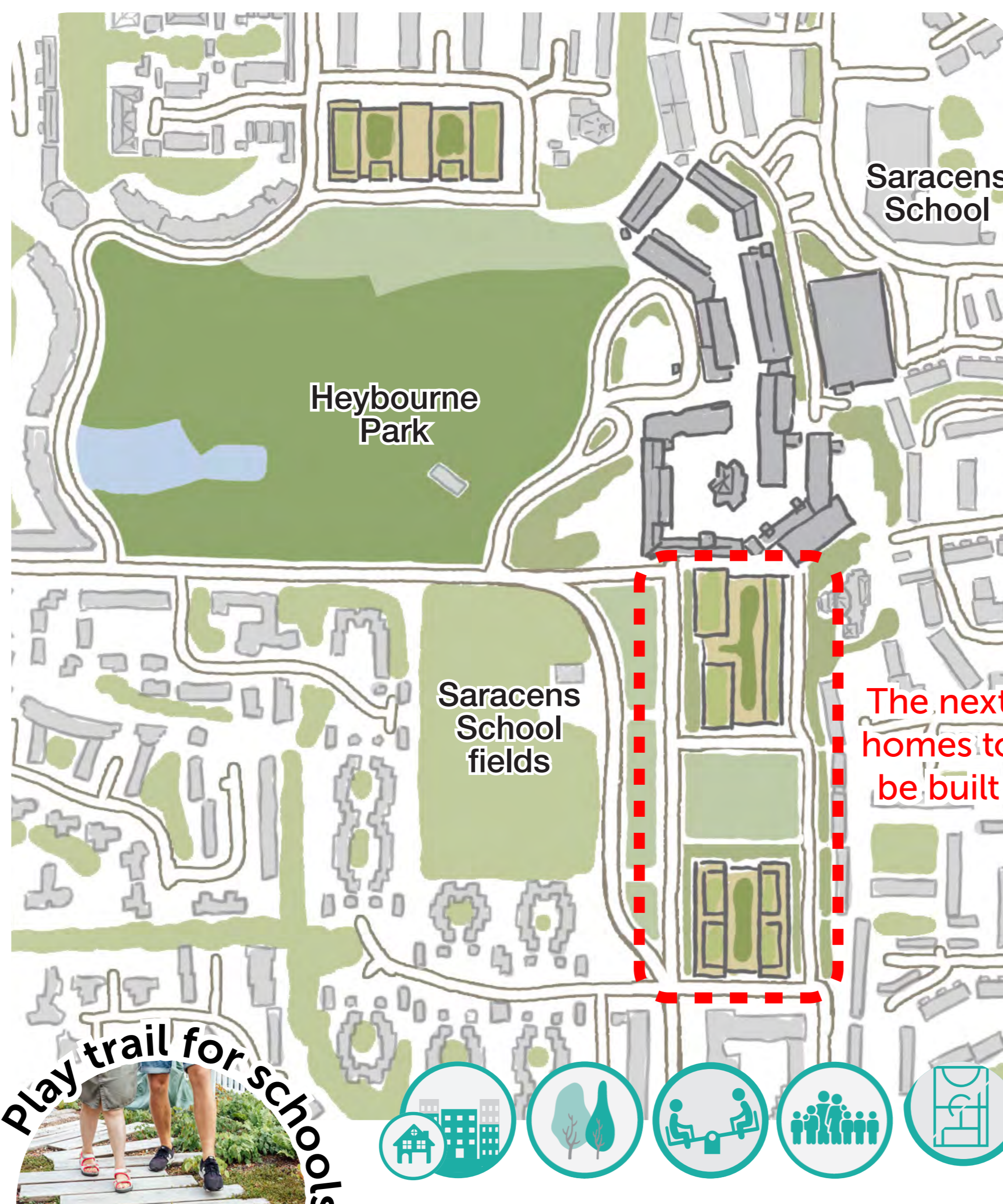
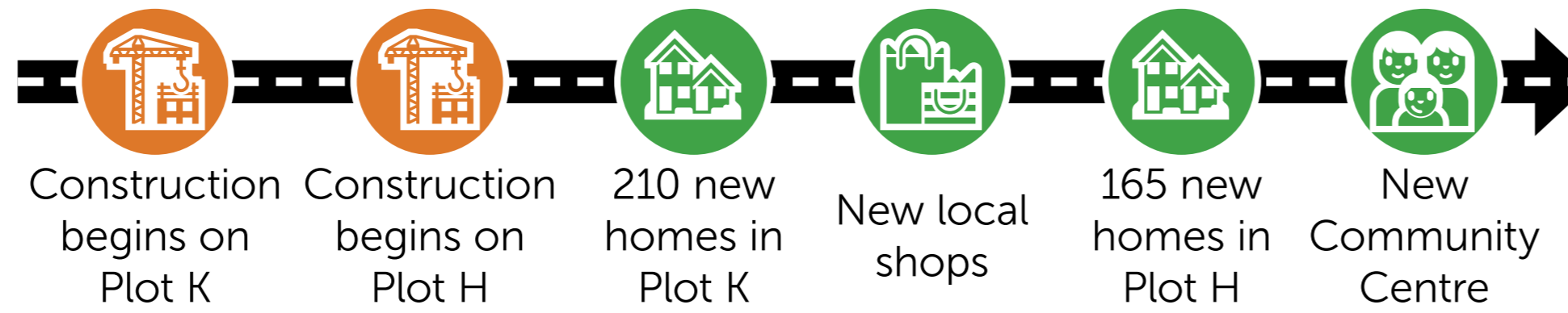

A range of new homes  
Sketch of Plot H townhouses



# Delivering places over time

HK202

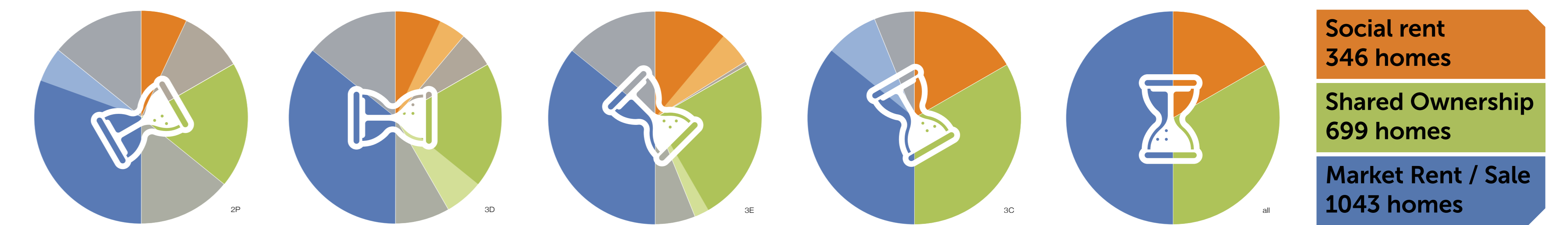

by 2030  
1000 homes

by 2037  
2088 homes

Social rent	346 homes
Shared Ownership	699 homes
Market Rent / Sale	1043 homes



New active streets  
Sketch of Bristol Avenue

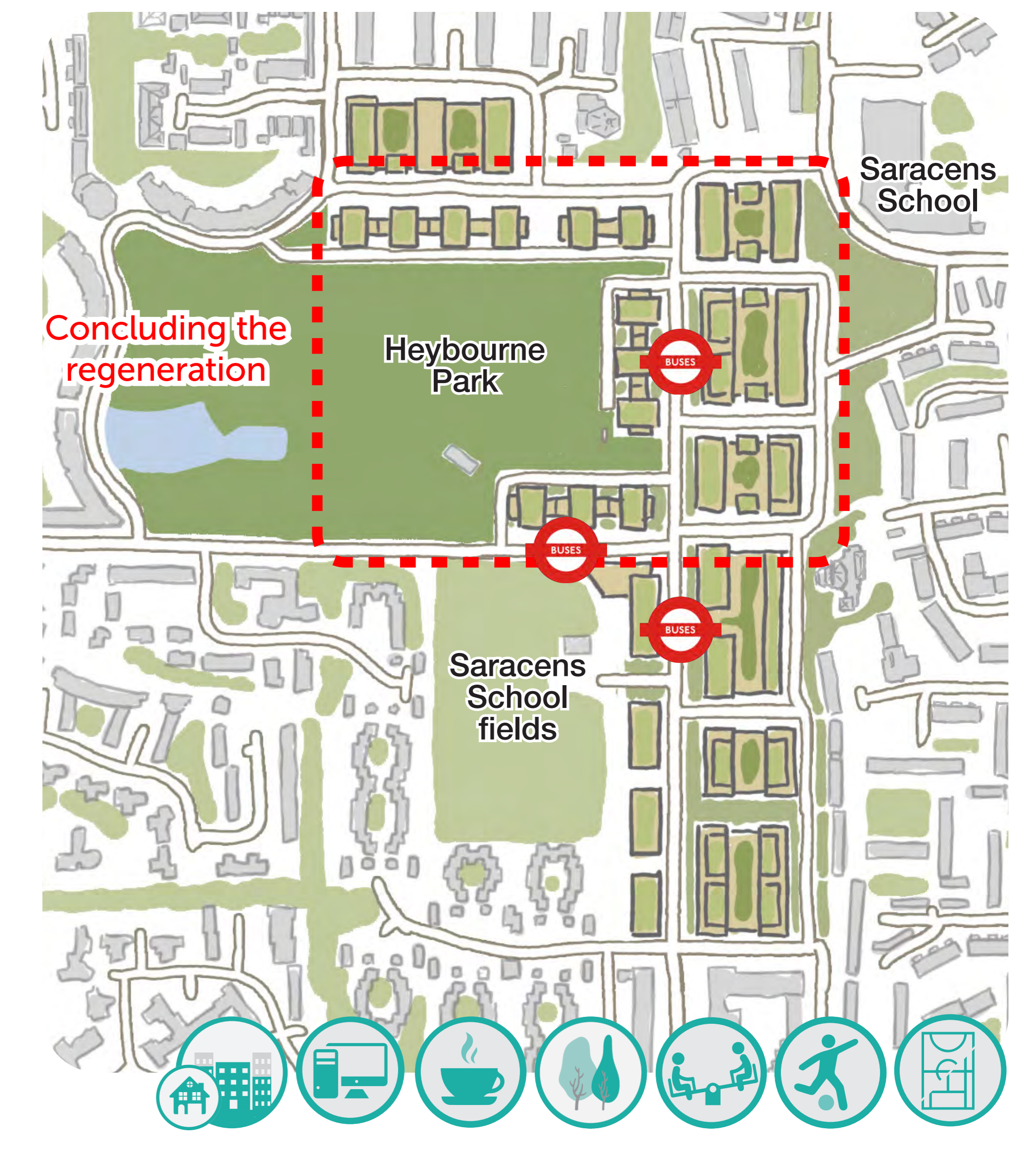
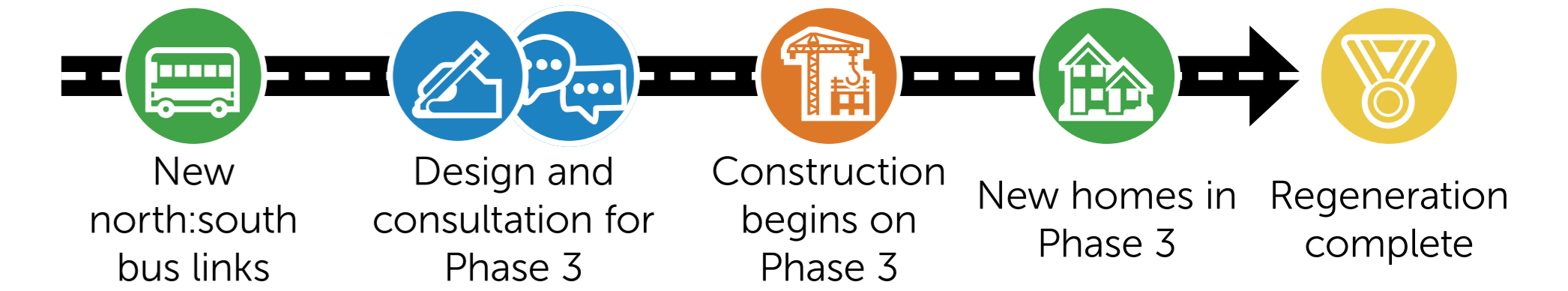

Parkside living  
Sketch of the Terrace

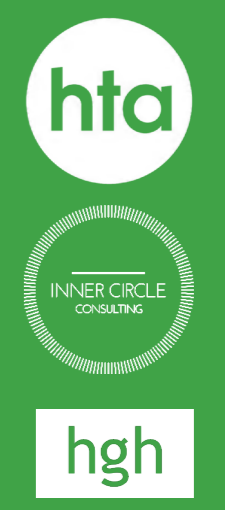

# Greening the new spaces

HK203

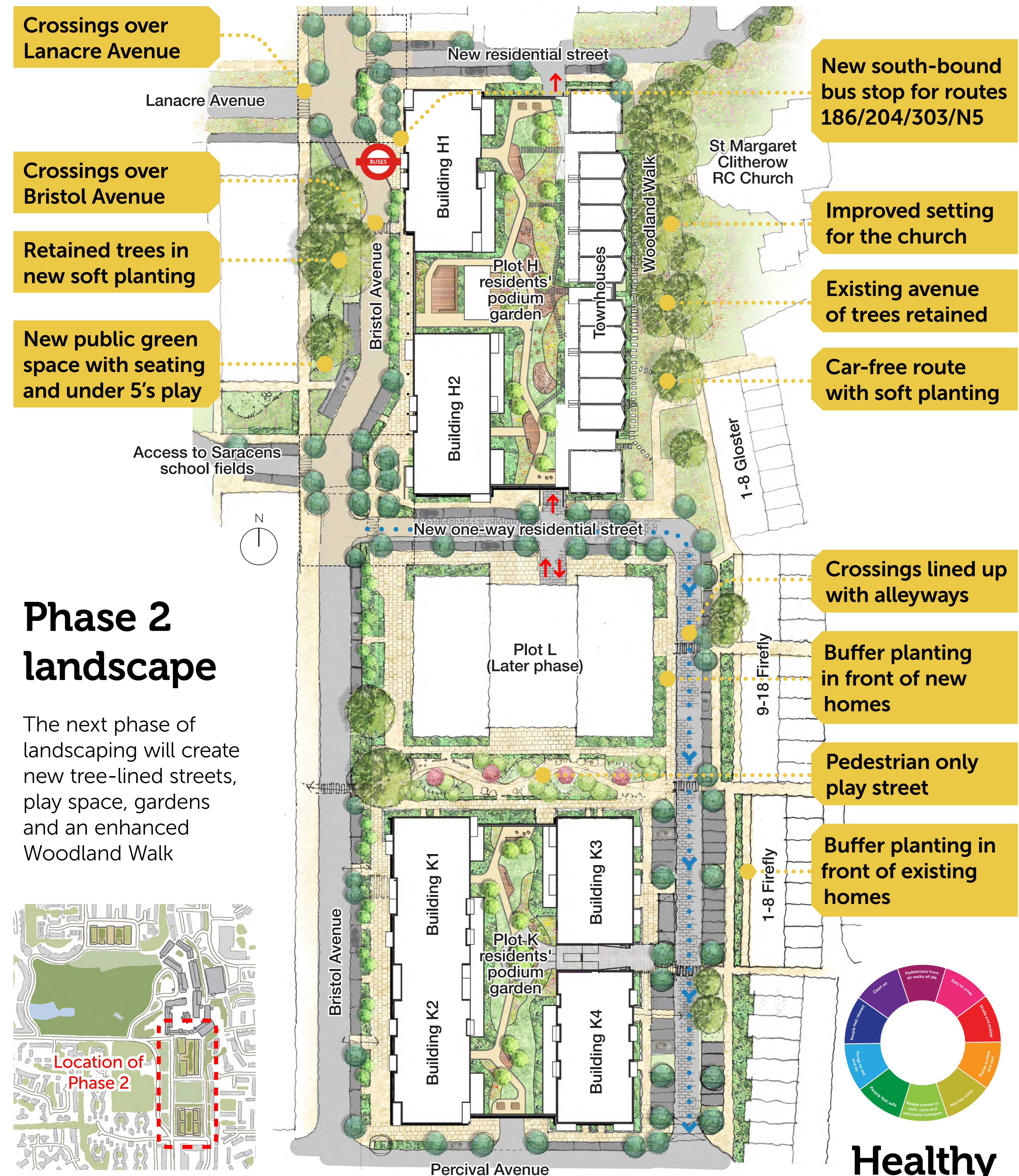

**You Said - we Did**

Retain as many existing trees as possible and plant new ones...

**Tell us what you think!**

Improving walking and cycling in the public realm



# The public realm

HK204

**Open Space**

**Play Street**

**Have your say...**

- What types of play are most used in the area?
- Are there any specific age groups that need more play and recreation opportunities?
- Would you like to have opportunities for exercise outdoors, like Trim-Trails and outdoor gym equipment?
- What sort of play equipment would you like to see in the public realm, natural play or more traditional fixed play?

**Get in touch**  
email us at [GrahaemePark@nhg.org.uk](mailto:GrahaemePark@nhg.org.uk)

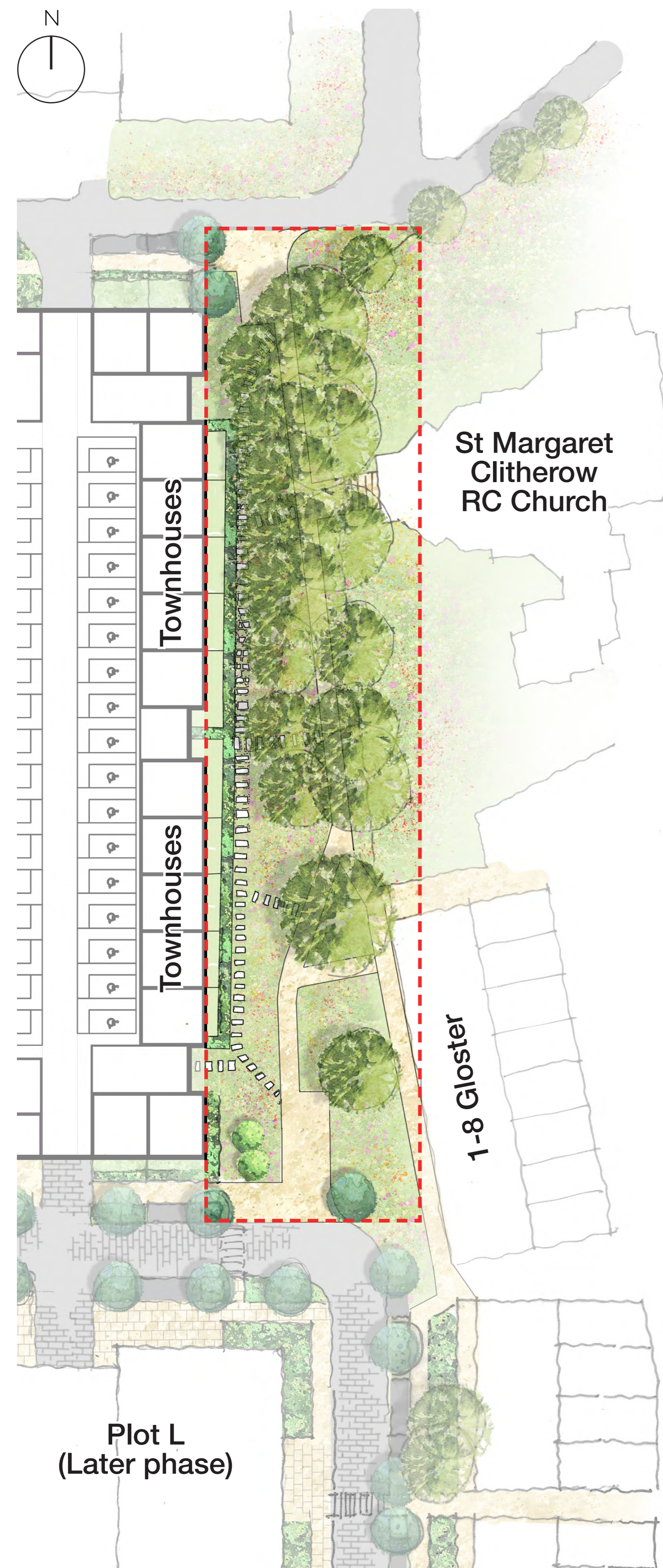

## What's changed.

- We have removed the street between Block H and St Margaret Clitherow RC Church to create a dedicated pedestrian and cycle route.
- We also have been able to retain most of the existing avenue of London Plane trees.
- There will be controlled vehicle access to service the town houses when required

### Precedents

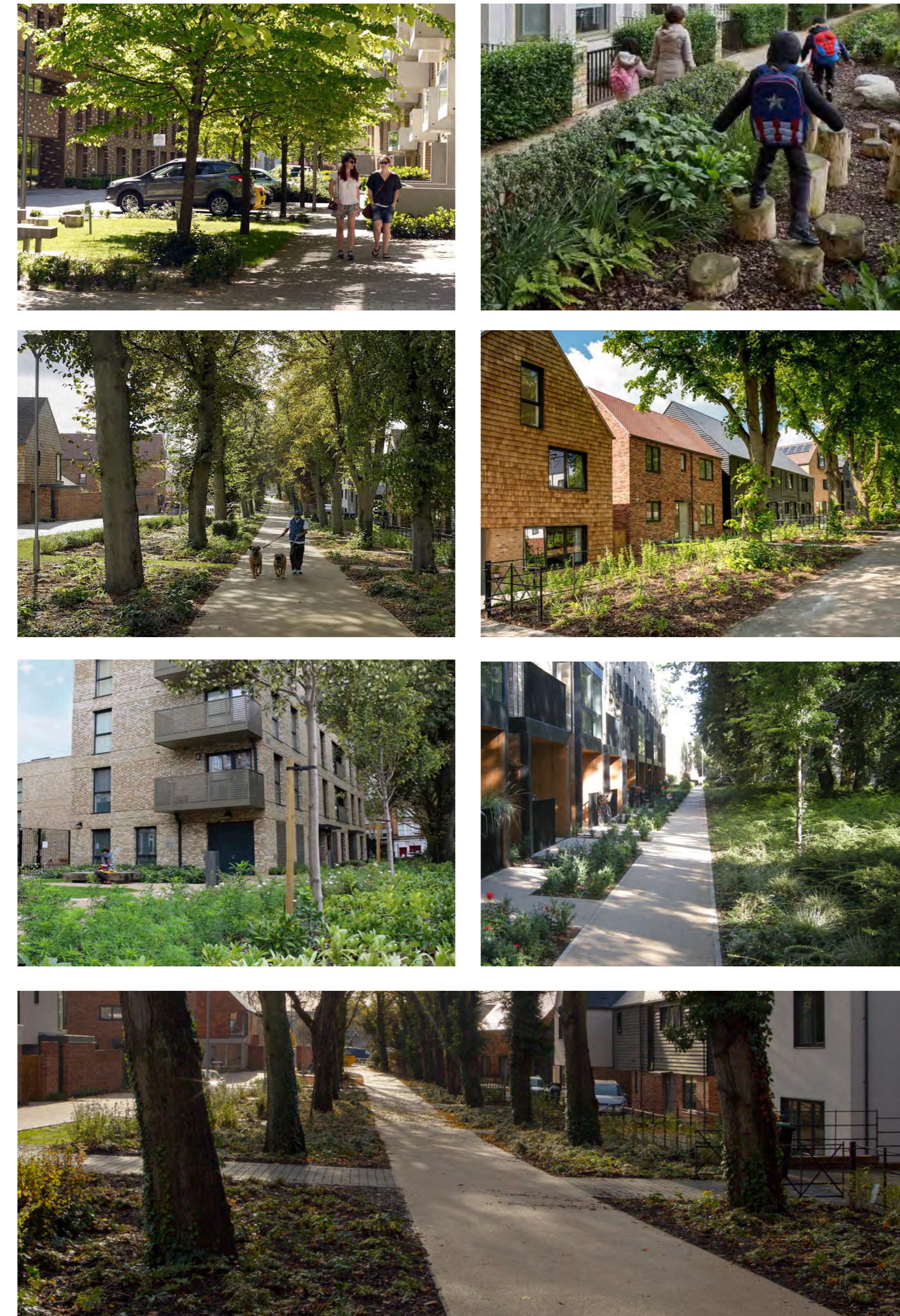

### Typical Section - Woodland Walk



## Have your say...

- What would you like to see here?
- Communal Cycle stands?
- Bench Seating?
- Is this a space the church may benefit from using for open days/events?
- Should the woodland walk be left primarily as a biodiverse wildlife corridor?

### Plot H

### Plot K

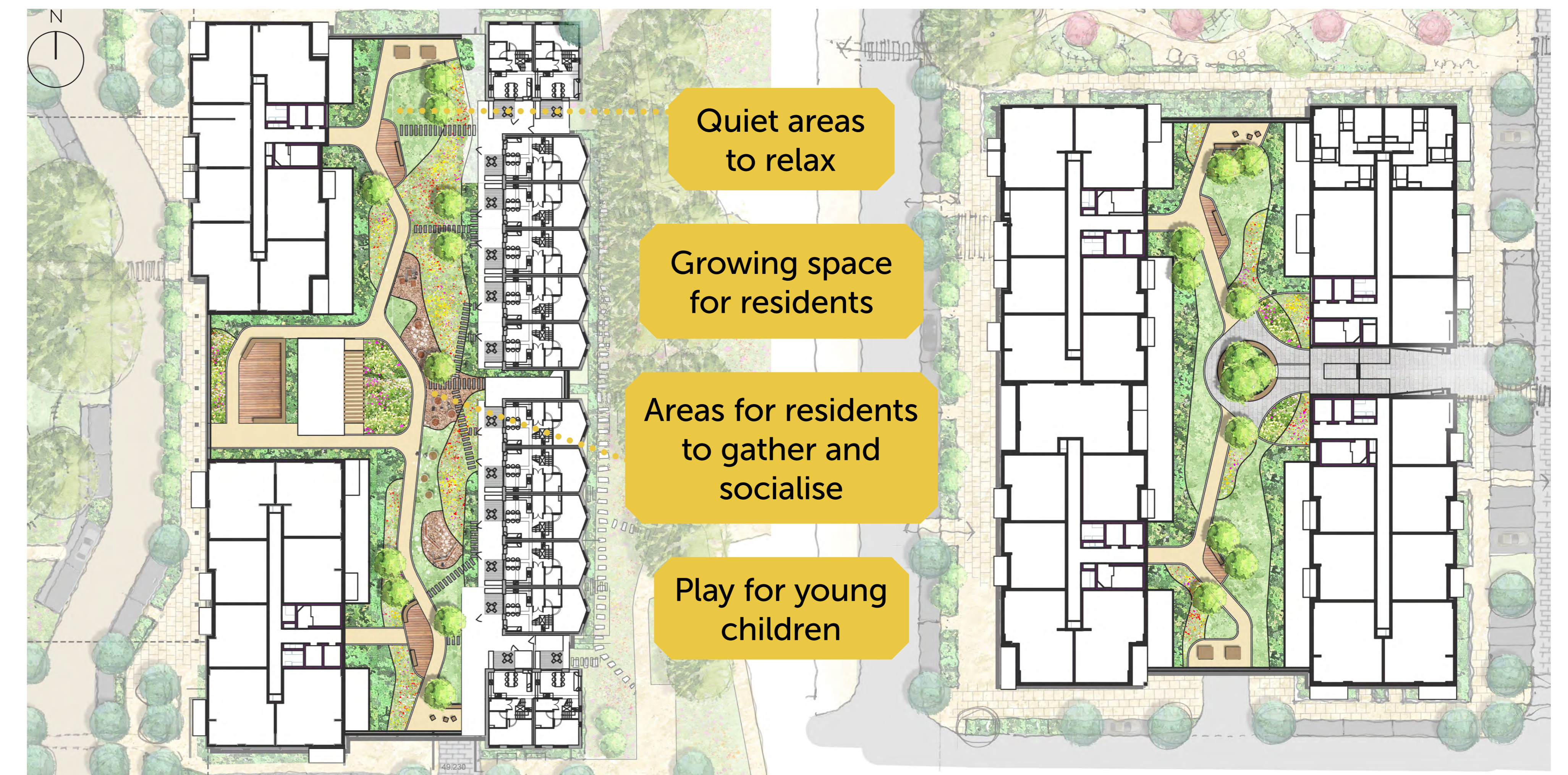

## If you lived here...

- What sort of play spaces would you like?
- Would you be interested in growing your own food or gardening?
- What other shared activities would you like?
- Would you like space for communal events?
- What makes a relaxing space for you?
- What sort of planting would you like to see?

### Typical Section - Podium Courtyard

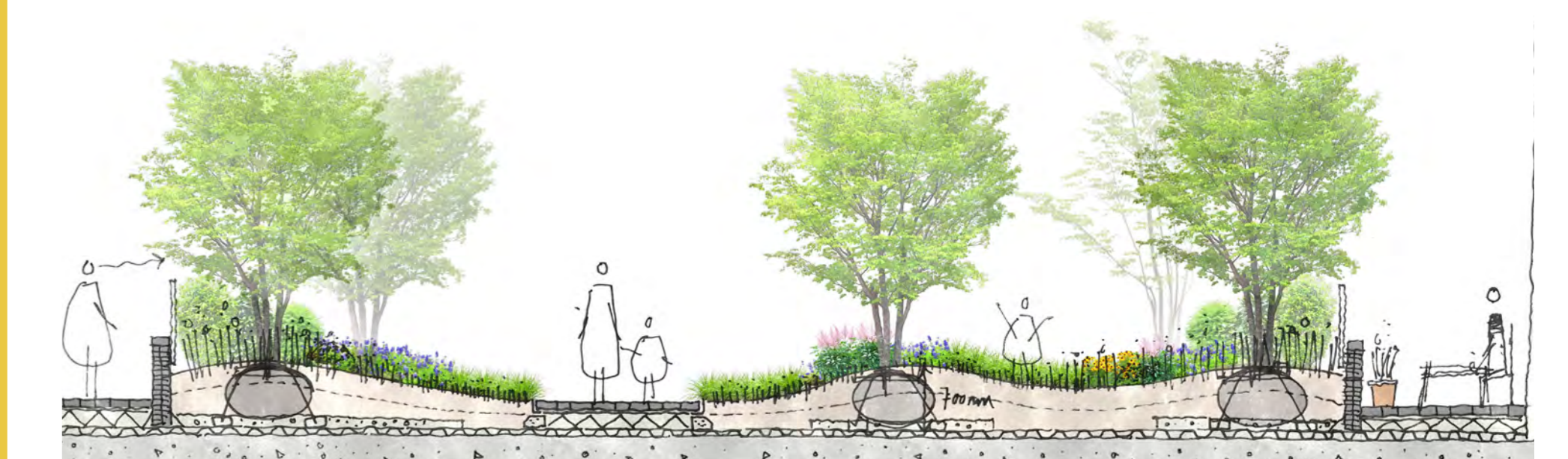

 **Have your say**



# Your new Community Centre

HK207

## A space for the whole community

Your new Community Centre will be built on the ground floor of Plot H, approached from Bristol Avenue, at a key location in the heart of the masterplan.

The centre faces onto existing mature planting and links to the site of the future nursery and children's centre.

We have been working closely with the Colindale Communities Trust to develop ideas for the Community Centre and are sharing those here

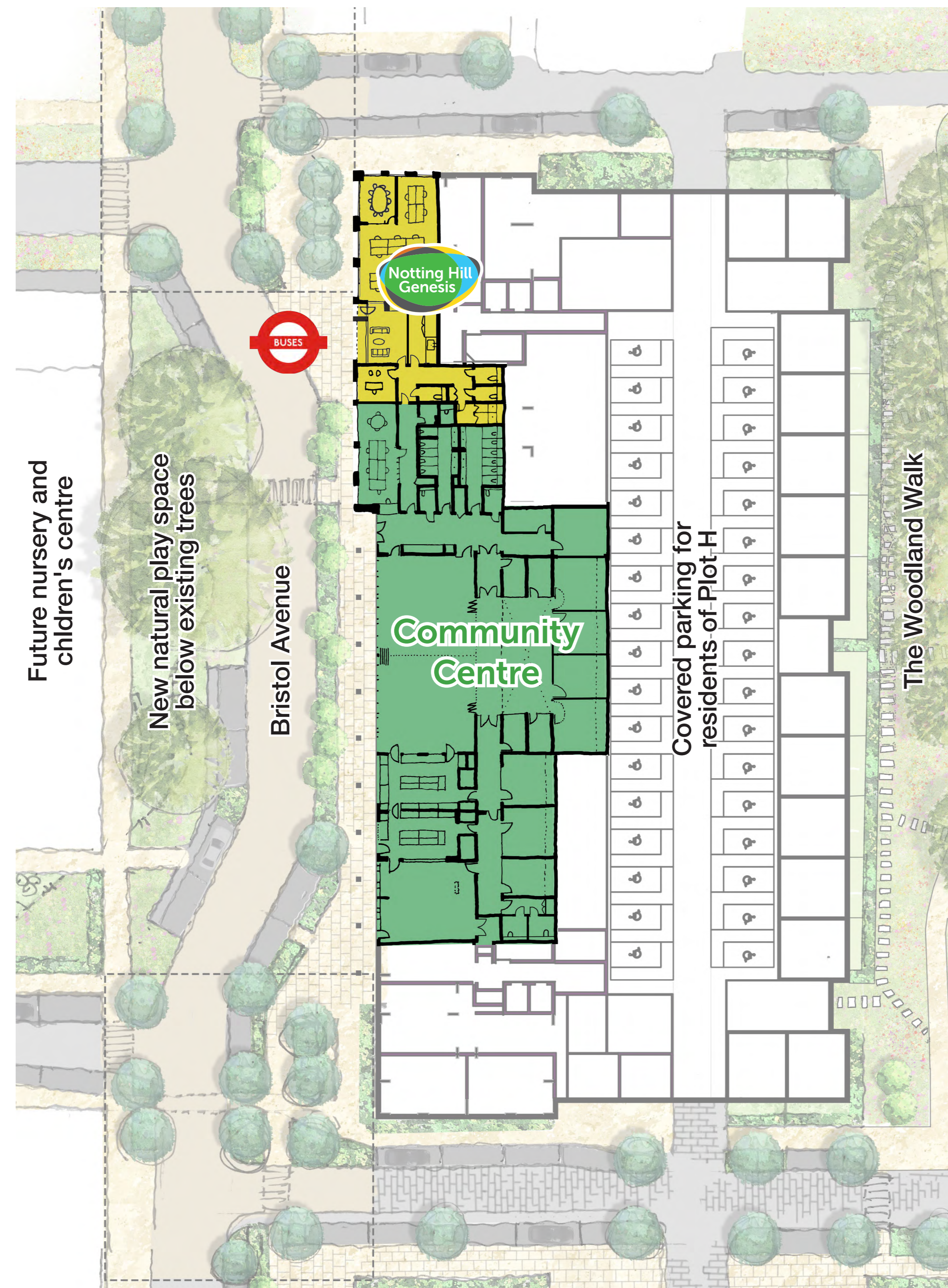

# Help us design to meet your needs

HK208

## Working...

- What sort of businesses might work here?
- Do you run a business looking for space?
- Do you work independently from home?
- Would you be interested in start-up space?
- Would you like to rent a desk space?
- Do you need a space to hold a market?



## Gathering...

- How would you use a flexible hall?
- Do you have a society or club?
- Would you hold a party or event here?
- Could you use a space for exhibitions?

## Learning...

- Would you attend fitness classes?
- Would you attend cookery classes?
- Would you like to learn new skills?
- Would you like more children's activities?



Principal Hall

Secondary Hall

Training Room

Group / Office spaces

Small spaces

Kitchen

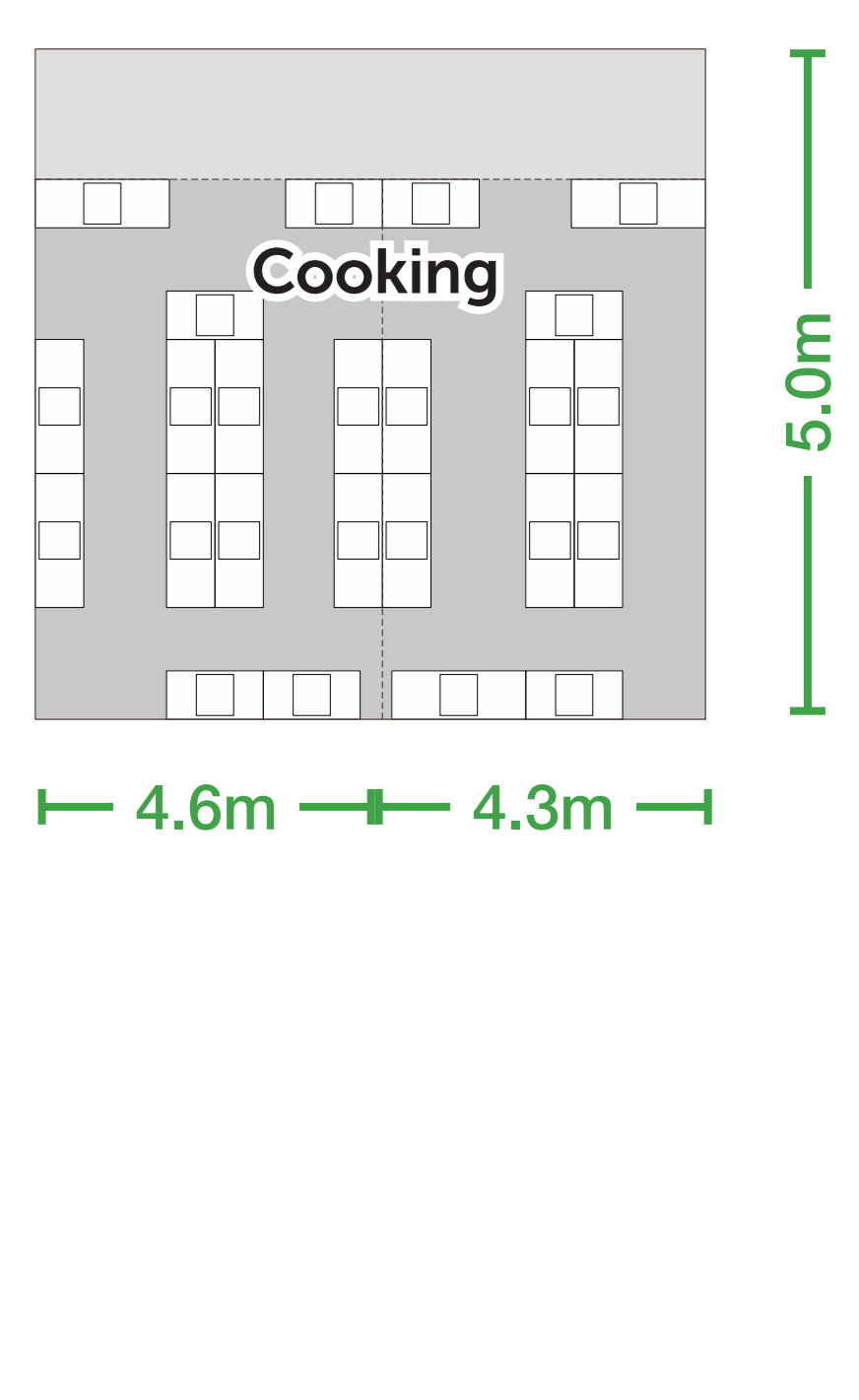
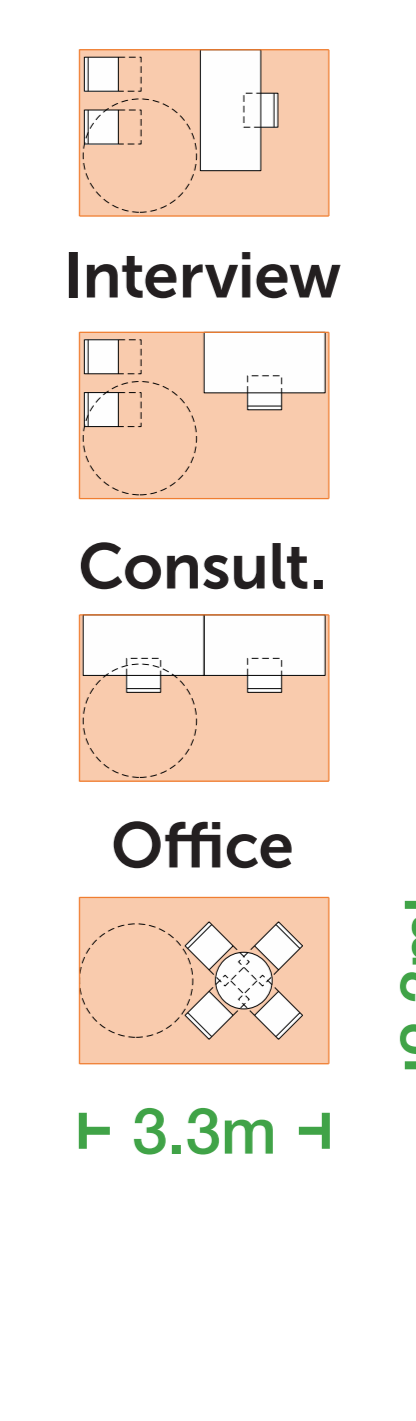
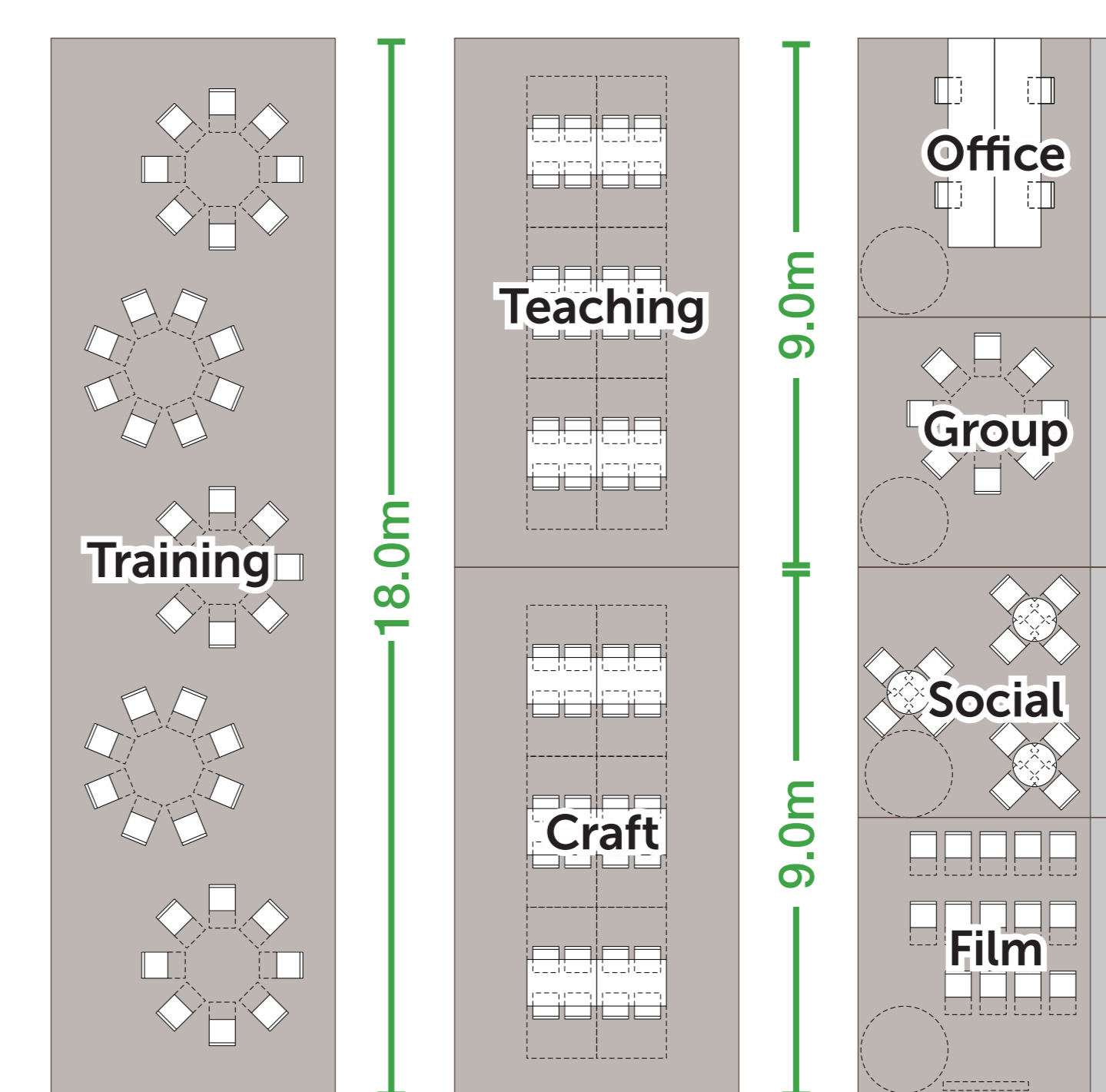
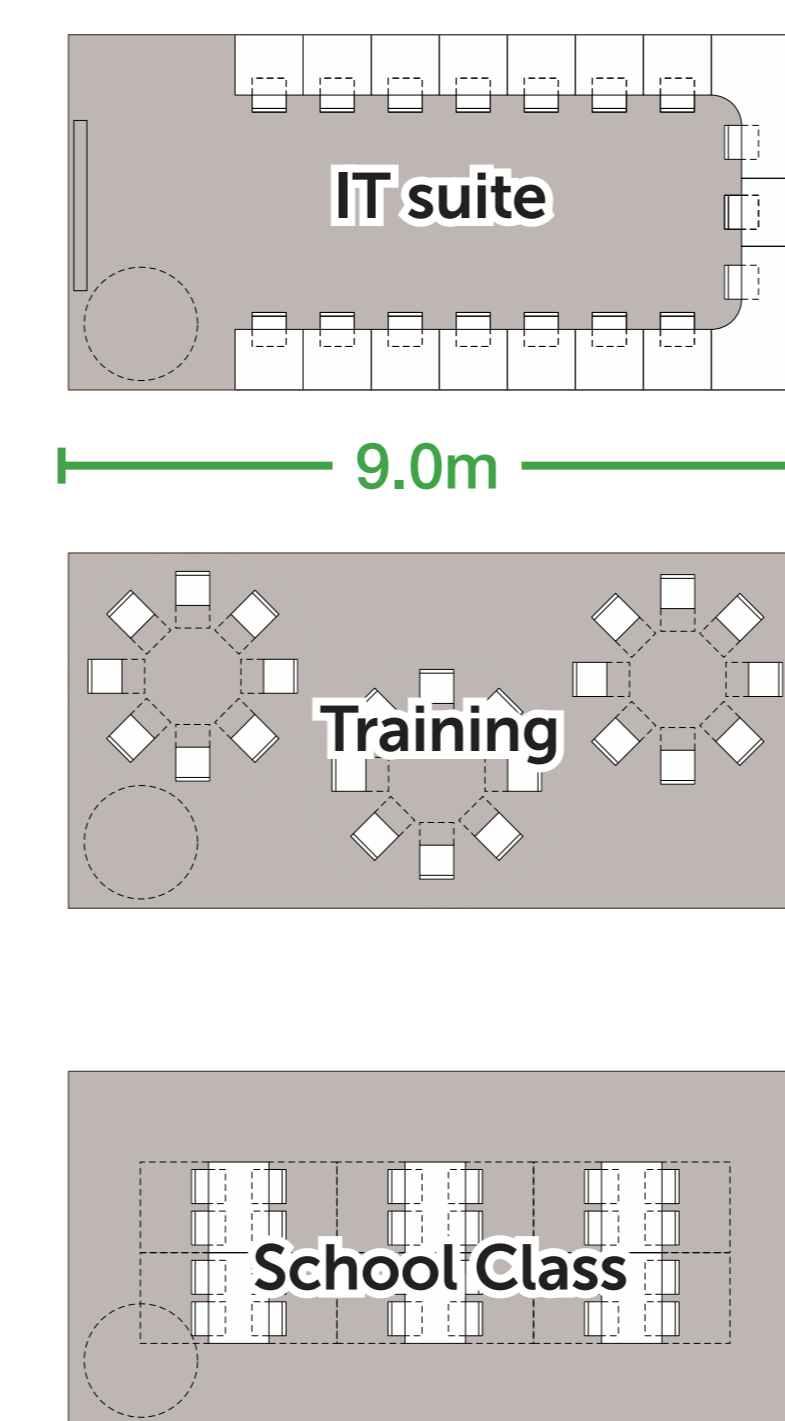
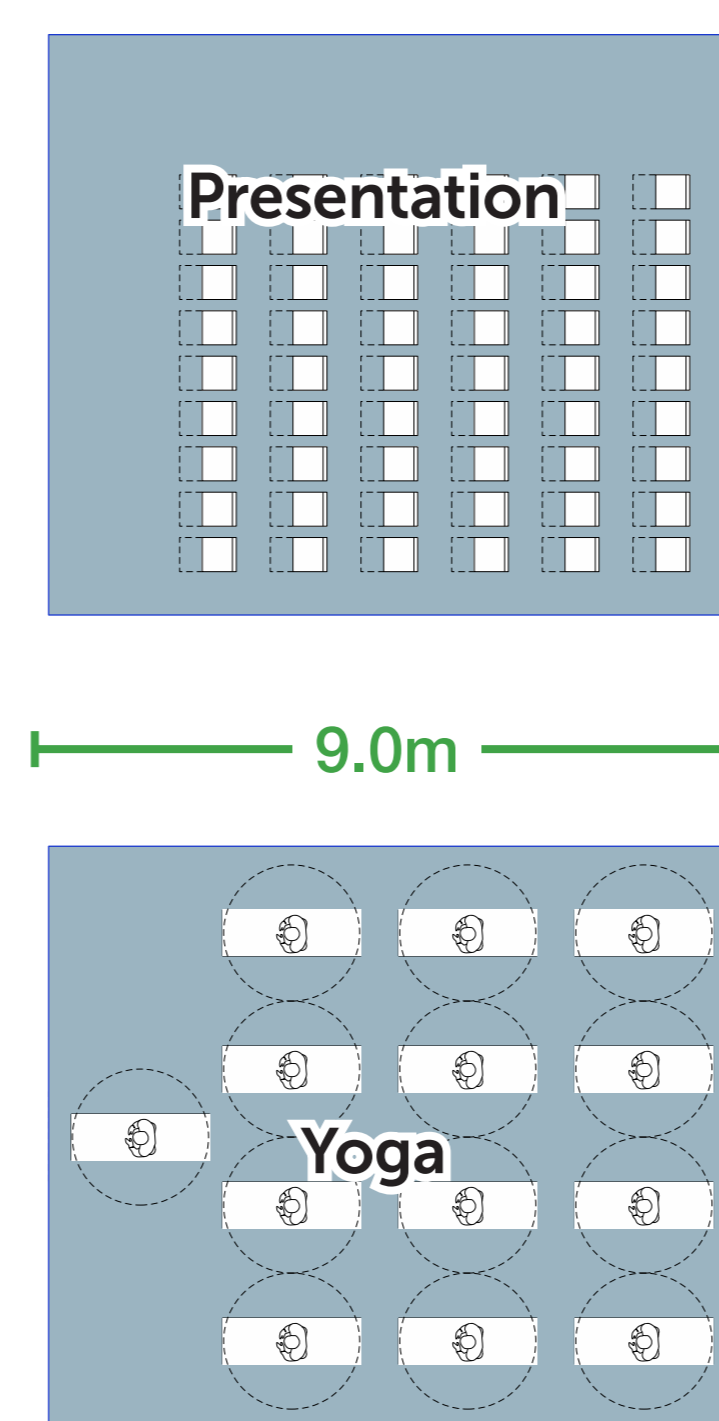
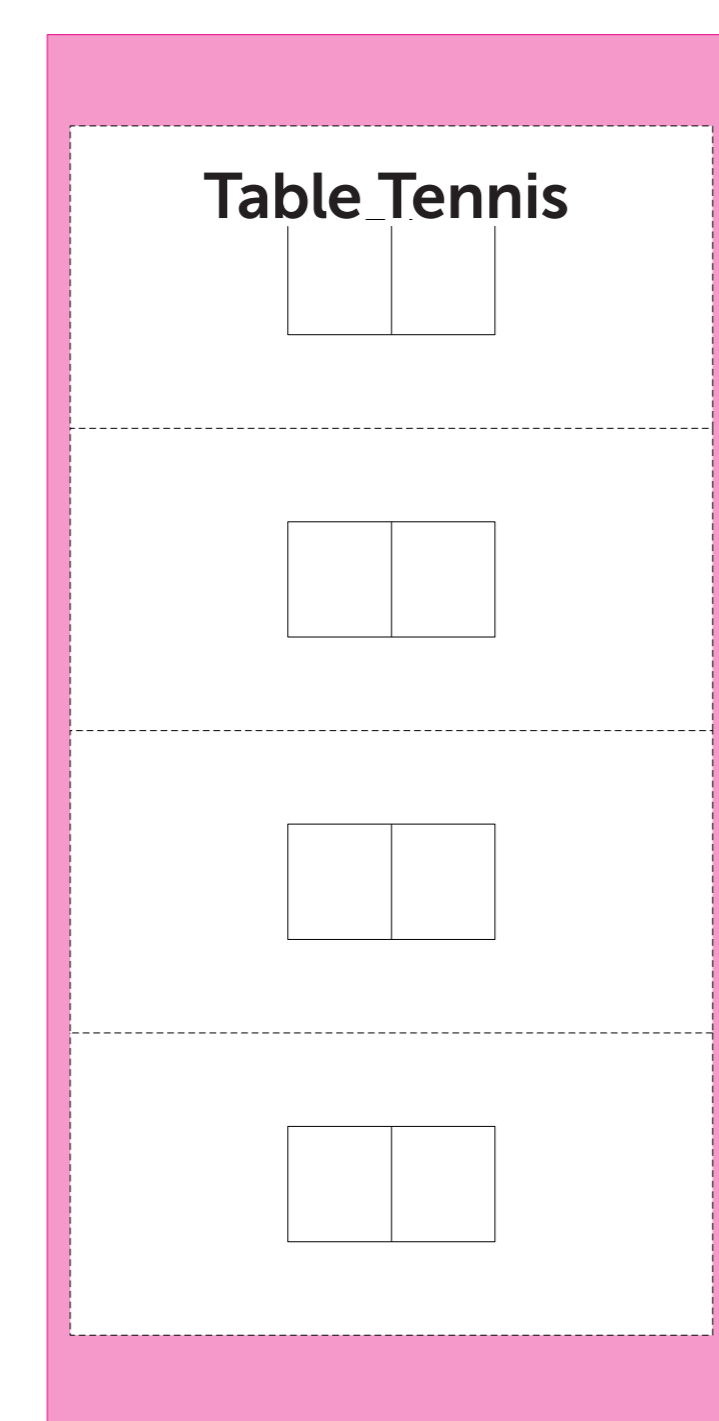
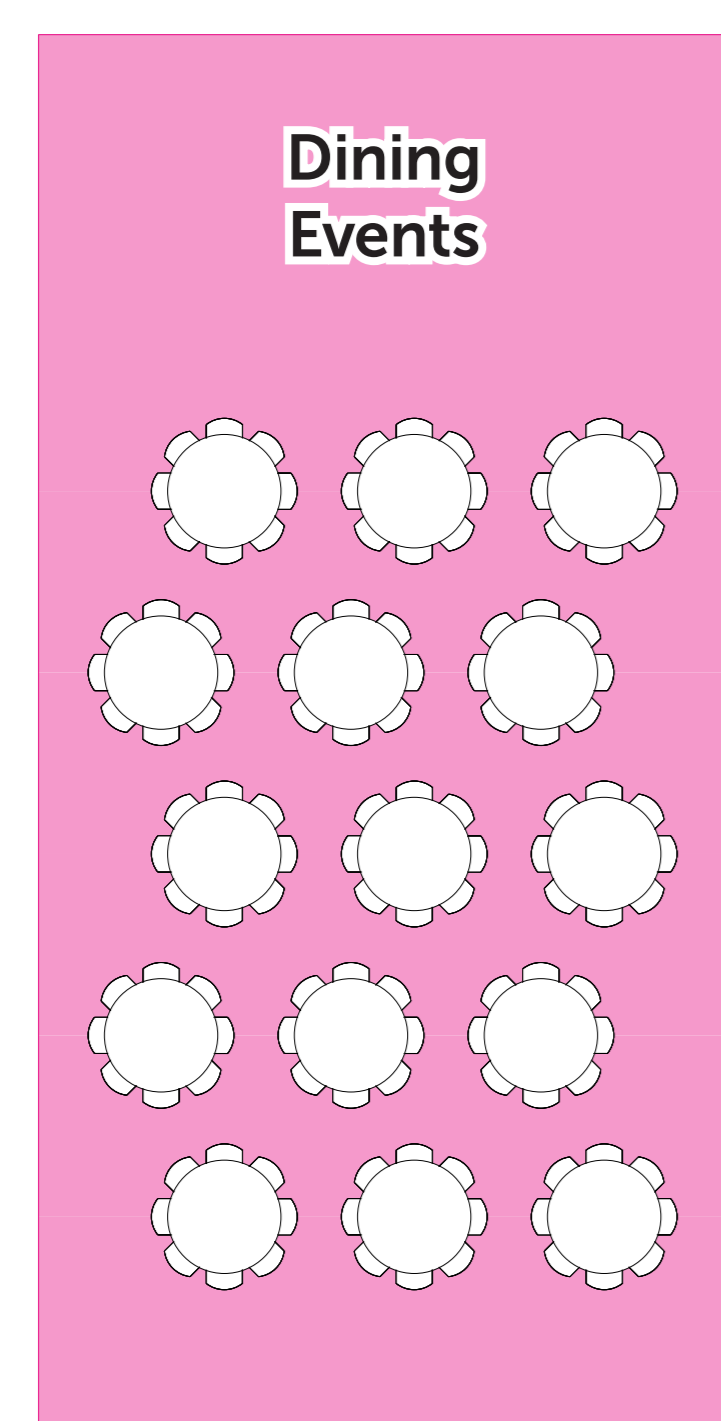
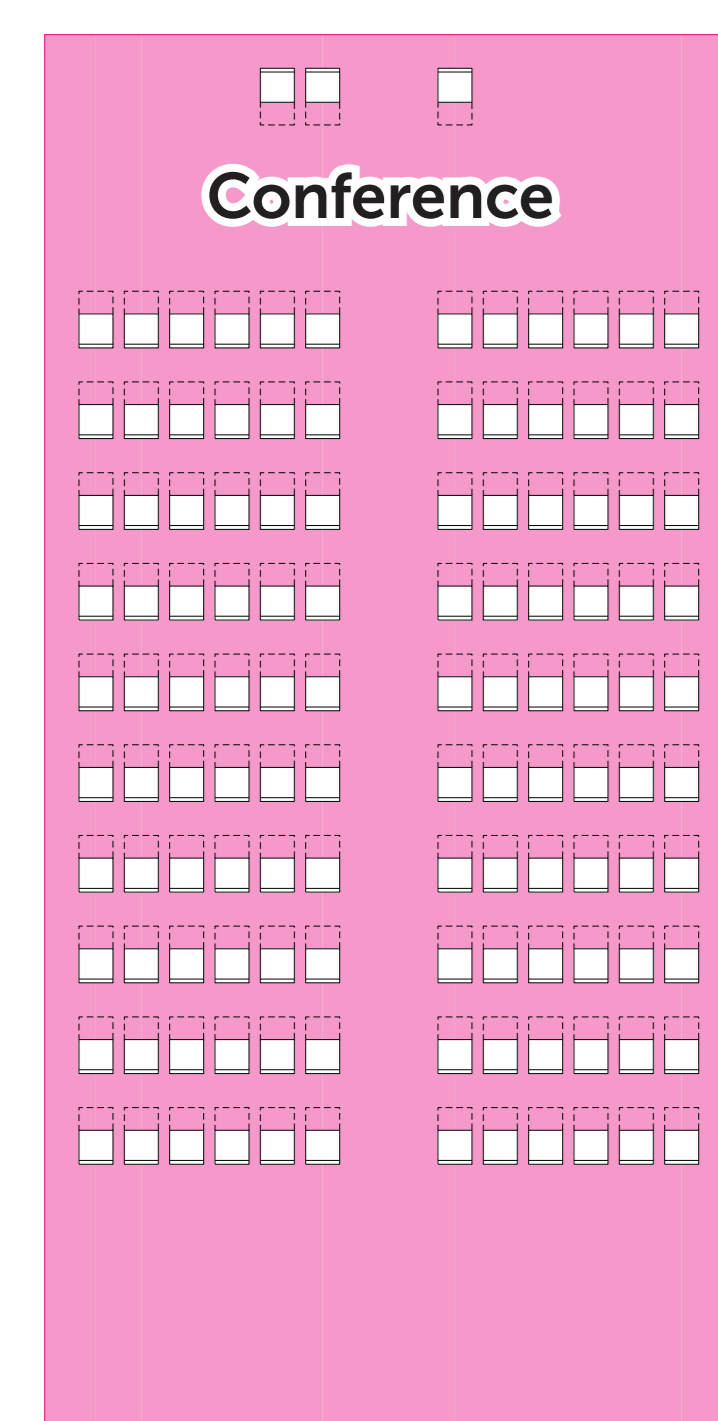

9.0m

9.0m

9.0m

9.0m

7.5m

9.0m

4.7m

18.0m

9.0m

9.0m

9.0m

5.0m

4.0m

4.0m

5.0m

4.7m

12.3m

3.3m

4.6m 4.3m

5.0m



Get in touch

email us at [GrahamePark@nhg.org.uk](mailto:GrahamePark@nhg.org.uk)

